

SITE LOCATION

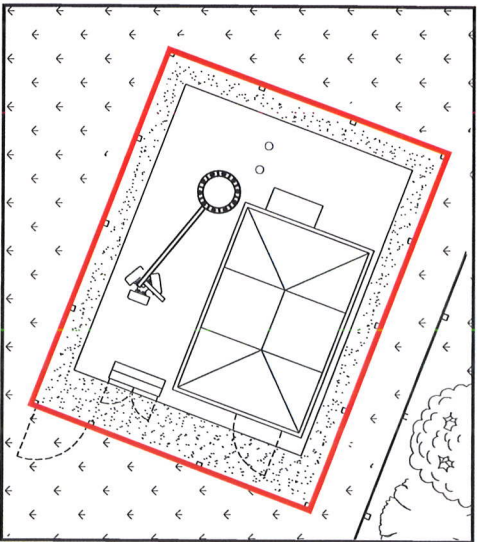

LEASE DEMISE PLAN  
(1:100)

27 NOV 2018  
ST0963/18TFUL

**DETAILED SITE LOCATION**  
(Scale 1:1250)  
Based upon Ordnance Survey map extract with the permission of the Controller of Her Majesty's Stationery Office.  
Crown copyright.  
Licence No. 100022432

The drawings comply with TEF & Vodafone Standard ICNIRP guidelines.  
Designed in accordance with CTL document: SDN0008

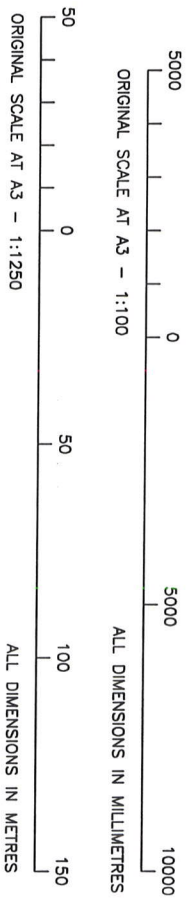

ALL DIMENSIONS IN MILLIMETRES

ALL DIMENSIONS IN METRES

ALL DIMENSIONS ARE IN mm UNLESS NOTED OTHERWISE

N.G.R	E: 437812 N: 563115
CONGESTION REQUIRED	NO

**DIRECTIONS TO SITE:**  
HEAD NORTHEAST ON A194(M). AT THE ROUNDABOUT, TAKE THE 2ND EXIT ONTO LEAM LANE/A194, GO THROUGH 2 ROUNDABOUTS, THEN AT THE NEXT ROUNDABOUT TAKE THE 3RD EXIT ONTO JOHN REDD ROAD/A1300, GO THROUGH 2 ROUNDABOUTS, THEN AT THE NEXT TAKE THE 4TH EXIT ONTO KING GEORGE ROAD/A1018 CONTINUE TO FOLLOW THE A1018/SHIELDS ROAD, GO THROUGH 1 ROUNDABOUT, AND THE SITE IS SITUATED IN THE FIELD ON THE RIGHT HAND SIDE

**NOTES:**

REV	DESCRIPTION	DATE	BY	CHK
B	Revised Mast	02/11/18	US	LB
A	Issued for Approval	23/08/18	CM	LB
	MODIFICATION	DATE	BY	CHK



Cell Name	Opt
WHEATHALL NORTH FARM	-
Cell ID No	VF
CTL	TEF
117083	47382
	N/A

Site Address / Contact Details	
TELECOMMUNICATION MAST	
SHIELDS ROAD	
CLEADON	
TNE & WEAR	
NE34 8AU	

Drawing Title	LEASE DEMISE PLAN
Purpose of Issue	PLANNING
Drawing Number	101
Survived By	PM
Date	23.08.18
Checked	LB
Date	23.08.18
Original Sheet Size	A3
Drawn	CM
Date	23.08.18
Checked	LB
Date	23.08.18
Original Sheet Size	A3
Drawn	CM
Date	23.08.18
Checked	LB
Date	23.08.18

Survived By	PM	Original Sheet Size	A3	Pack Issue	B
Date	23.08.18	Checked	LB	Date	23.08.18